

iButton reader/probe



- Description:

Reader has tinned cable ends in standard version (wire length can be customized from 10 cm up to 10 m). There is an opportunity to use indicating LED's according to individual requirements (customize version to common anode system or built-in resistors with requested value, into the header of reader).

## Mechanical drawings:

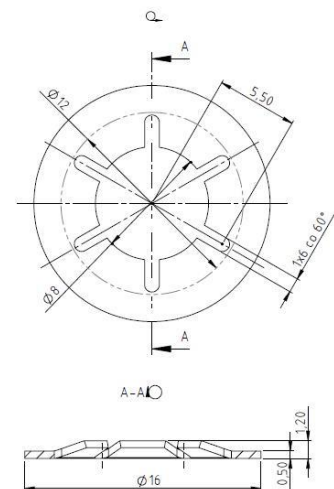

Electrical connection:

CZ-2-SS reader provides standard 1-wire® interface for connecting to other electronic devices, as following:

- white wire – iButton 1-wire® signal (see [electrical characteristics of DS1990A iButton](#))
- grey wire – iButton grounding

And connection for two built-in LED's with common cathode:

- brown wire – red LED anode
- green wire – green LED anode
- yellow wire – LED's common cathode (see [electrical characteristics of Kingbright LED - KPБ-3025SURKCGKC](#))

Connection diagram for CZ-2-SS reader:

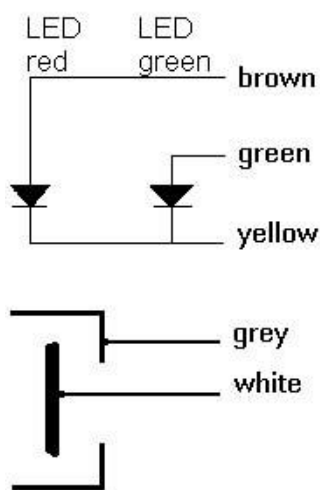

**Important:** Providing power source value higher than maximum value of  $V_F$  voltage (2,5 V for  $I_F = 20$  mA) specified for LED is not recommended. If required – use the appropriate resistors for each type of LED.